

PW3139KW

20V P-Channel MOSFET

-0.66A -20V; $R_{DS(ON)typ}=440m\Omega@-4.5V$, $R_{DS(ON)typ}=620m\Omega@-2.5V$,
 $R_{DS(ON)typ}=810m\Omega@-1.8V$.

FEATURE

- Surface Mount Package
- P-Channel Switch with Low $R_{DS(on)}$
- Operated at Low Logic Level Gate Drive

Application

- Load/Power Switching
- Interfacing, Logic Switching
- Battery Management for Ultra Small Portable Electronics

MARKING:

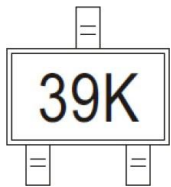

SOT-323

1. GATE
2. SOURCE
3. DRAIN

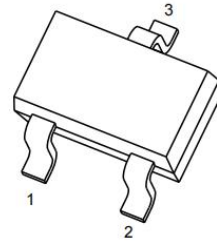

Schematic diagram

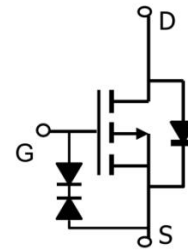

ABSOLUTE MAXIMUM RATINGS ($T_a=25^\circ\text{C}$ unless otherwise noted)

Parameter	Symbol	Value	Unit
Drain-Source Voltage	V_{DS}	-20	V
Gate-Source Voltage	V_{GS}	± 12	V
Continuous Drain Current	I_D	-0.66	A
Plused Drain Current ⁽¹⁾	I_{DM}	-2.64	A
Power Dissipation ⁽²⁾	P_D	200	mW
Thermal Resistance from Junction to Ambient ⁽¹⁾	$R_{\theta JA}$	625	$^\circ\text{C}/\text{W}$
Junction Temperature	T_J	150	$^\circ\text{C}$
Storage Temperature	T_{STG}	-55~ +150	$^\circ\text{C}$

MOSFET ELECTRICAL CHARACTERISTICS(T_a=25°C unless otherwise noted)

Parameter	Symbol	Test Condition	Min	Type	Max	Unit
STATIC CHARACTERISTICS						
Drain-source breakdown voltage	V _{(BR)DSS}	V _{GS} = 0V, I _D = -250μA	-20			V
Zero gate voltage drain current	I _{DSS}	V _{DS} = -20V, V _{GS} = 0V			-1	uA
Gate-body leakage current	I _{GSS}	V _{GS} = ±10V, V _{DS} = 0V			±20	uA
Gate threshold voltage ⁽³⁾	V _{GS(th)}	V _{DS} = V _{GS} , I _D = -250μA	-0.35	-0.45	-1.1	V
Drain-source on-resistance ⁽³⁾	R _{DSON}	V _{GS} = -4.5V, I _D = -0.5A		440	570	mΩ
		V _{GS} = -2.5V, I _D = -0.3A		620	830	
		V _{GS} = -1.8V, I _D = -0.12A		810	1100	
Forward transconductance	g _{FS}	V _{DS} = -10V, I _D = -0.50A	0.8			S
DYNAMIC CHARACTERISTICS⁽⁴⁾						
Input Capacitance	C _{iss}	V _{DS} = -16V, V _{GS} = 0V, f = 1MHz			175	pF
Output Capacitance	C _{oss}				25	
Reverse Transfer Capacitance	C _{rss}				15	
SWITCHING CHARACTERISTICS⁽⁴⁾						
Turn-on delay time	t _{d(on)}	V _{DS} = -10V, I _D = -200mA, V _{GS} = -4.5V, R _G = 10Ω		9		nS
Turn-on rise time	t _r			5.7		
Turn-off delay time	t _{d(off)}			32.6		
Turn-off fall time	t _f			20.3		
SOURCE-DRAIN DIODE CHARACTERISTICS						
Diode Forward voltage ⁽³⁾	V _{DS}	I _S = -0.5A, V _{GS} = 0V			-1.2	V

Notes :

- 1.Repetitive Rating: Pulse width limited by maximum junction temperature.
- 2.This test is performed with no heat sink at T_a=25°C.
- 3.Pulse Test : Pulse Width ≤ 300 μ s, Duty Cycle ≤ 0.5%.
- 4.These parameters have no way to verify.

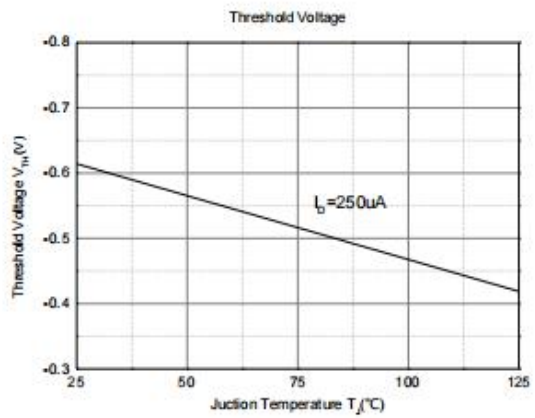
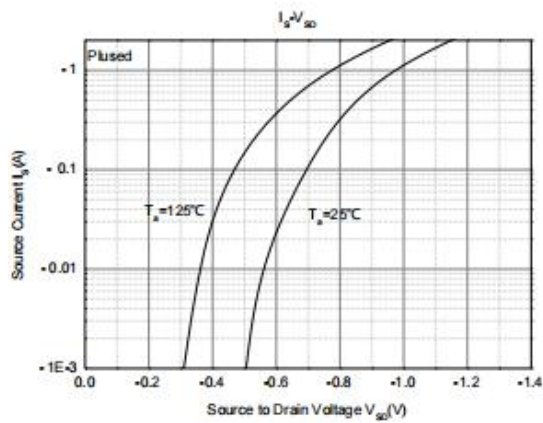
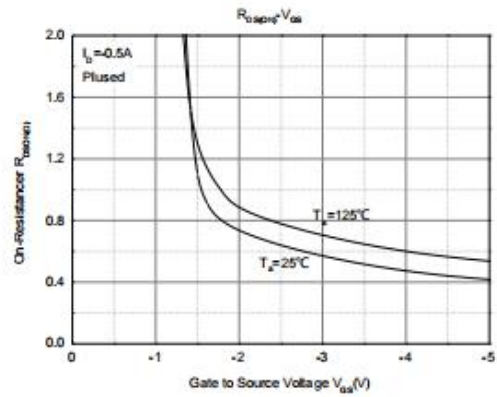
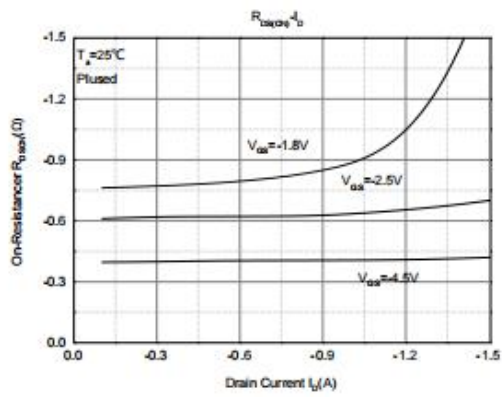
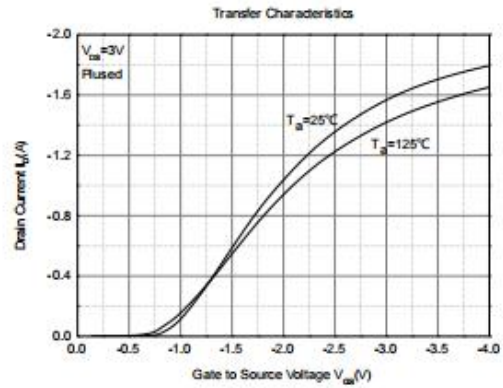
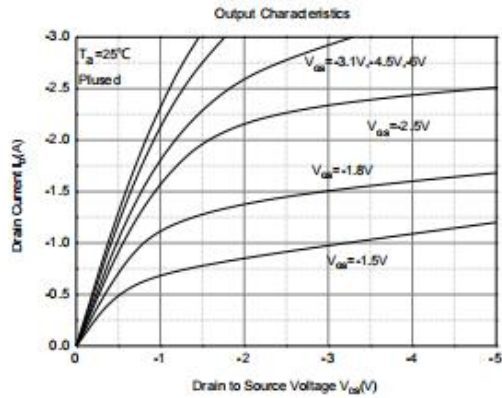

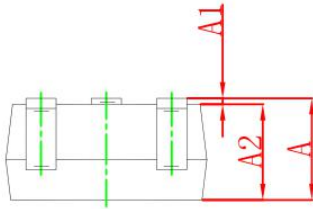
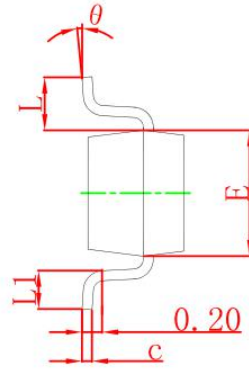
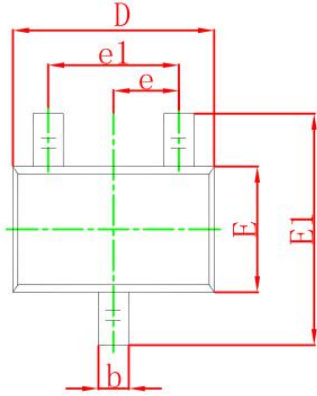

Symbol	Dimensions In Millimeters		Dimensions In Inches	
	Min	Max	Min	Max
A	0.900	1.100	0.035	0.043
A1	0.000	0.100	0.000	0.004
A2	0.900	1.000	0.035	0.039
b	0.200	0.400	0.008	0.016
c	0.080	0.150	0.003	0.006
D	2.000	2.200	0.079	0.087
E	1.150	1.350	0.045	0.053
E1	2.150	2.450	0.085	0.096
e	0.650 TYP		0.026 TYP	
e1	1.200	1.400	0.047	0.055
L	0.525 REF		0.021 REF	
L1	0.260	0.460	0.010	0.018
θ	0°	8°	0°	8°

SOT-323 Tape and Reel

SOT-323 Embossed Carrier Tape

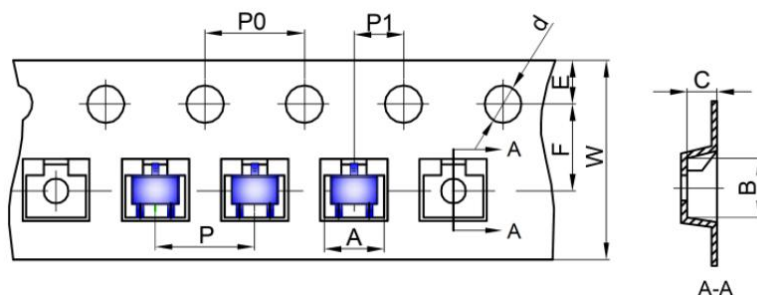

Dimensions are in millimeter										
Pkg type	A	B	C	d	E	F	P0	P	P1	W
SOT-323	2.25	2.55	1.19	Ø1.55	1.75	3.50	4.00	4.00	2.00	8.00

SOT-323 Tape Leader and Trailer

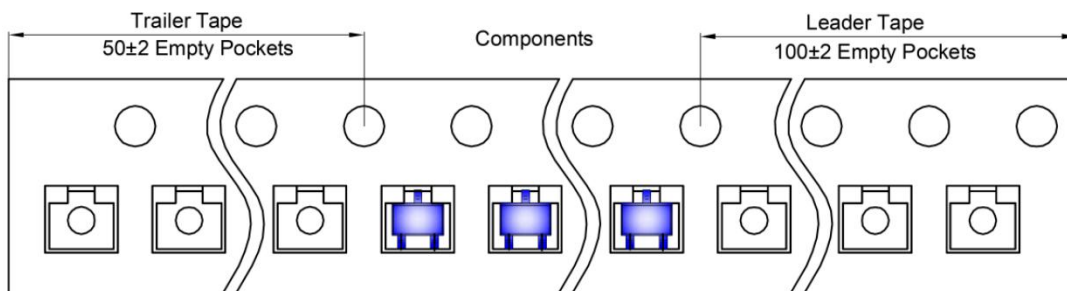

SOT-323 Reel

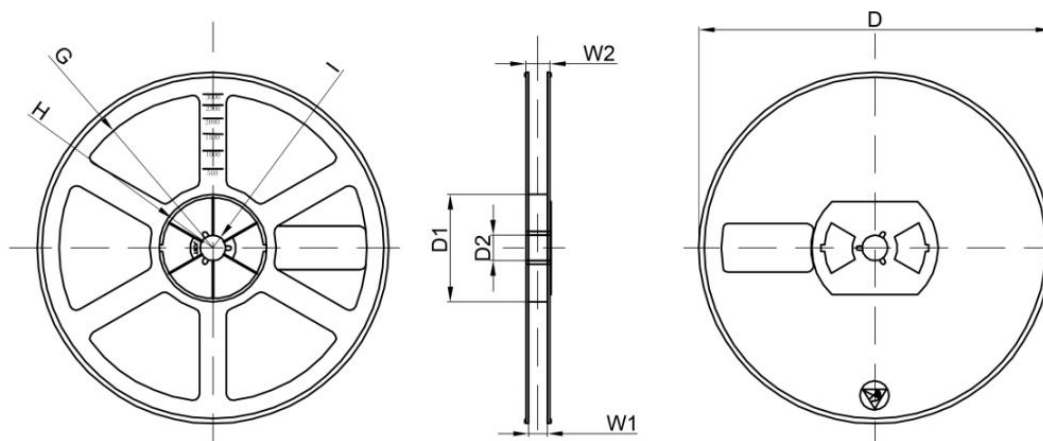

Dimensions are in millimeter								
Reel Option	D	D1	D2	G	H	I	W1	W2
7" Dia	Ø178.00	54.40	13.00	R78.00	R25.60	R6.50	9.50	12.30

REEL	Reel Size	Box	Box Size(mm)	Carton	Carton Size(mm)	G.W.(kg)
3000 pcs	7 inch	30,000 pcs	203×203×195	120,000 pcs	438×438×220	